

LIFE SAFETY PLAN: GENERAL NOTES

- OCCUPANT LOAD PER 2018 NFPA 101 LSC AND 2018 IBC TABLE 1004.1.2.
- EGRESS WIDTH PER NFPA 101:
- STAIR FACTOR 0.3" PER OCCUPANT
- OTHER 0.2" PER OCCUPANT
- EXIT ACCESS TRAVEL DISTANCE = 250' FOR R-1 WITH NFPA 13 SPRINKLERS PER 2018 IBC TABLE 1017.2.
- MAXIMUM TRAVEL DISTANCE TO FIRE EXTINGUISHER CABINETS FROM ANY POINT IN THE BUILDING IS 75'-0" PER 906.3.2018 IFC.
- INSTALL FIRE EXTINGUISHERS PER CITY REQUIREMENTS WITHIN 75' TRAVEL DISTANCE SPACING.
- FIRE EXTINGUISHER TO BE SURFACE MOUNTED ON CONCRETE/CMU WALLS AND IN SERVICE AREAS. RECESS MOUNTED IN MTLWOOD STUD WALLS. PROVIDE IN ACCORDANCE WITH PLANS & LOCAL FIRE MARSHALL DIRECTION. CONTRACTOR TO COORDINATE ROUGH OPENING FOR SEMI-RECESSED AND FULLY RECESSED FIRE EXTINGUISHER CABINETS. REFER TO PLANS FOR ARCHITECT'S DESIRED LOCATIONS.
- NEW CORRIDOR EXTINGUISHERS TO BE MARKED FEC-1. SEMI-RECESSED FIRE EXTINGUISHER CABINET BY COSMOPOLITAN, 1026 TRIM 1 1/2" INCH SQ. VERTICAL DUO WITH SAF-FLOK. CLEAR ACRYLIC GLASS, COSMIC 10E FIRE EXTINGUISHER. EXISTING EXTINGUISHERS TO BE VERIFIED FOR CODE COMPLIANCE AND BEST BY DATE BY GC.
- PORTABLE FIRE EXTINGUISHERS (PER SECTION 906) TO BE MOUNTED SO THE OPERATION LATCH IS BELOW 48" A.F.F. THE RATED SEMI-RECESSED CABINET CAN NOT PROTRUDE MORE THAN 4". TOP OF CABINET SHALL BE AT 50" AFF. MAX. REF 1/16-030 FOR ADDITIONAL INFORMATION.
- PRECAST/CONCRETE STRUCTURAL ELEMENTS SHALL PROVIDE THE MIN. FIRE RESISTANCE PER 2018 IBC TABLE 721.1(2).
- DEAD-END CORRIDORS NOT TO EXCEED 50' FOR ARRANGEMENT OF MEANS OF EGRESS 34.2.5.2 WITH NFPA 13 SPRINKLERS.
- TWO EXITS OR EXIT ACCESS DOORWAYS SHALL BE PROVIDED FROM ANY SPACE WITH AN OCCUPANT LOAD OF 1 TO 49.
- A TWO-WAY COMMUNICATION SYSTEM SHALL BE PROVIDED AT THE LANDING SERVING EACH ELEVATOR OR BANK OF ELEVATORS ON EACH ACCESSIBLE FLOOR THAT IS ONE OR MORE STORIES ABOVE OR BELOW THE LEVEL OF EXIT DISCHARGE. PER 2018 IBC SECTION 1009.8. TWO-WAY COMMUNICATION IS NOT REQUIRED AT SERVICE ELEVATORS THAT ARE NOT PART OF THE ACCESSIBLE MEANS OF EGRESS, PER EXCEPTION 2.
- REFER SHEETS A-132, A-133, A-134, AND A-135 FOR ADDITIONAL INFORMATION ON EXIT SIGNAGE.

LIFE SAFETY PLAN SYMBOLS

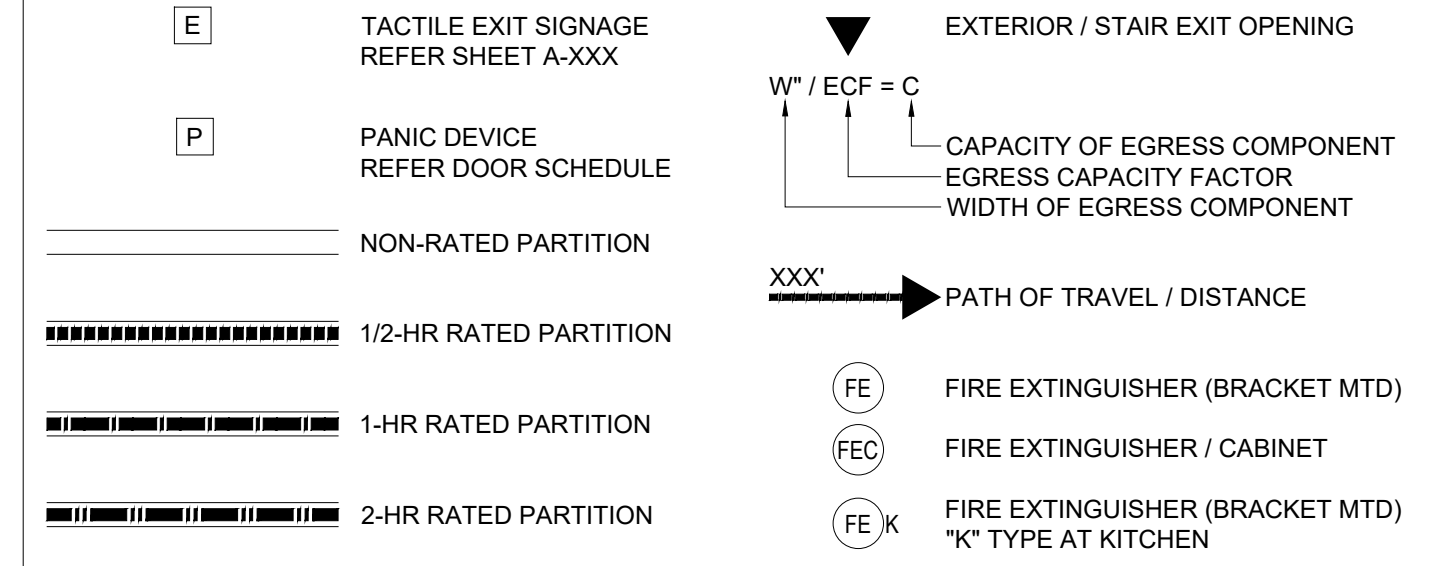

STIPULATION FOR REUSE:
 THIS DRAWING WAS PREPARED FOR USE ON A SPECIFIC SITE AT DULUTH, GA CONTEMPORANEOUSLY WITH ITS ISSUE DATE AS NOTED BELOW, AND IT IS NOT SUITABLE FOR USE ON A DIFFERENT PROJECT SITE OR AT A LATER TIME. USE OF THIS DRAWING FOR REFERENCE OR EXAMPLE ON ANOTHER PROJECT REQUIRES THE SERVICES OF PROPERLY LICENSED ARCHITECTS AND ENGINEERS. REPRODUCTION OF THIS DRAWING FOR REUSE ON ANOTHER PROJECT IS NOT AUTHORIZED AND MAY BE CONTRARY TO THE LAW.



CONSULTANTS:

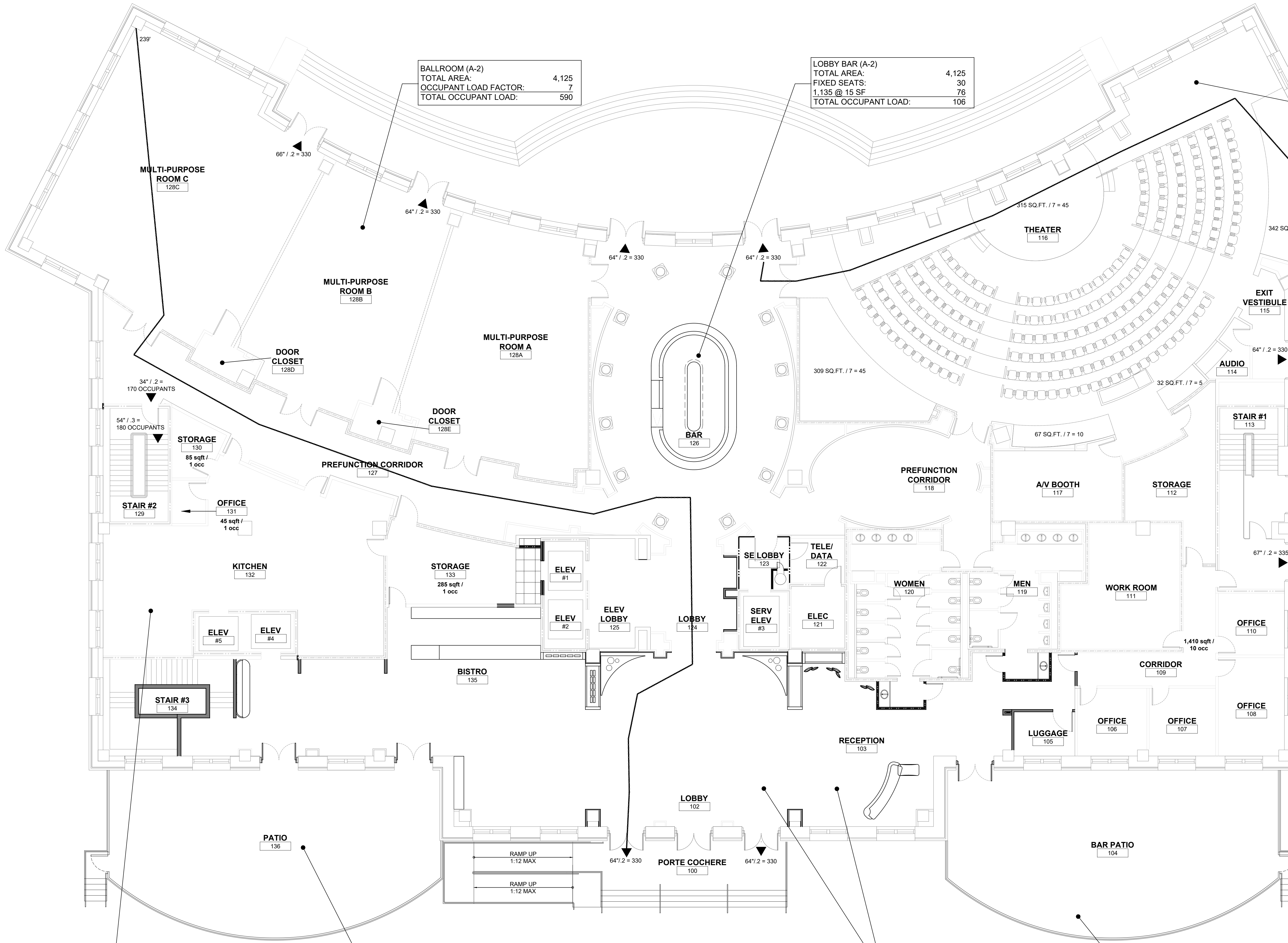

BALLROOM (A-2)
 TOTAL AREA: 4,125
 OCCUPANT LOAD FACTOR: 7
 TOTAL OCCUPANT LOAD: 590

LOBBY BAR (A-2)
 TOTAL AREA: 4,125
 FIXED SEATS: 30
 1,135 @ 15 SF
 TOTAL OCCUPANT LOAD: 106

THEATER (A-1)
 TOTAL AREA: 4,190
 FIXED SEATS: 212
 FLEX AREAS AT 7 SQ.FT./PERSON: 153
 TOTAL OCCUPANT LOAD: 365

KITCHEN (B)
 TOTAL AREA (GROSS): 1,260
 OCCUPANT LOAD FACTOR: 200
 TOTAL OCCUPANT LOAD: 7

DINING/BISTRO (A-2)
 TOTAL AREA: 2,740
 OCCUPANT LOAD FACTOR: 15
 TOTAL OCCUPANT LOAD: 183

LOBBY
 TOTAL AREA: 2,340
 OCCUPANT LOAD FACTOR: 15
 TOTAL OCCUPANT LOAD: 156

BAR PATIO
 TOTAL AREA: 1,740
 OCCUPANT LOAD FACTOR: 15
 TOTAL OCCUPANT LOAD: 116

LIFE SAFETY PLAN: ANALYSIS

FIRST FLOOR

OCCUPANT LOAD			
FLOOR ANALYSIS			
OCCUPANCY	AREA	LOAD FACTOR	OCCUPANTS
A-1: THEATER	4,190	-	-
- FIXED SEATS		212 SEATS	212
- FLEX SEATING AREA	1,065	7	153
A-2: MULTIPURPOSE ROOM	4,125	7	590
A-2: BAR	1,485		
- FIXED SEATS		30 SEATS	30
- FLEX SEATING AREA	1,135	15	76
COMMERCIAL KITCHEN	1,260	200	7
A-2: DINING/BISTRO	2,740	15	183
LOBBY/RECEPTION	2,340	15	156
BAR PATIO	1,740	15	116
B: OFFICE	1,410	150	10
S: STORAGE/MECH	860	300	3
			1,536

EXIT ACCESS TRAVEL DISTANCE
 MAX EXIT TRAVEL DISTANCE PER 2018 IBC TABLE 1017.2: 250'-0"
 MAX EXIT TRAVEL DISTANCE PROVIDED: 239'-0"

EXITS
 EXITS REQUIRED PER 2018 IBC TABLE 1006.3.3: 4
 EXITS PROVIDED: 9

EXIT DOOR WIDTH
 DOOR WIDTH REQUIRED PER NFPA 101:
 DOOR WIDTH PROVIDED: 32" CLEAR OPENING WIDTH
 36" CLEAR OPENING WIDTH (39" DOOR) AT STAIRWAYS
 33" CLEAR OPENING WIDTH AT EXIT DOORS

EGRESS WIDTH - DOORS
 EGRESS WIDTH REQUIRED PER NFPA 101:
 0.2" PER OCCUPANT x 1,536 OCCUPANTS = 308"
 EGRESS WIDTH PROVIDED:
 (17) 36" DOORS = 33" CLEARANCE PER DOOR = 561"
 9 EXITS PROVIDE DISCHARGE AT GROUND LEVEL

EGRESS WIDTH - STAIRS
 EGRESS WIDTH REQUIRED PER NFPA 101:
 EGRESS WIDTH PROVIDED:
 (1) 54" STAIRS = 54"

DEAD END CORRIDORS
 NO CORRIDORS CONTAIN DEAD ENDS GREATER THAN 20-FEET IN LENGTH PER NFPA 101, 2018 IBC 1020.5, EXCEPTION 2.

EXITS
 2018 IBC 1022.2.2: EXITS DOORS SHALL LEAD DIRECTLY TO THE EXIT DISCHARGE OR THE PUBLIC WAY.
 - STAIR 1 DISCHARGES TO THE EXTERIOR OF THE BUILDING AT FIRST FLOOR.
 - STAIR 2 DISCHARGES TO THE EXTERIOR OF THE BUILDING AT BASEMENT.

ISSUE BLOCK:

DOCUMENT DATE: xx/xx/2025

DRAWN BY:

CHECKED BY:

PROJECT NO.: JHD-024-NA-100002

SHEET TITLE:

LIFE SAFETY PLAN: STAIRWELL SIGNAGE

STAIRWELL IDENTIFICATION SIGNAGE SHALL COMPLY WITH THE 2018 EDITION OF NFPA 101, ARTICLES 7.2.2.5.4.1 (A) THROUGH 7.2.2.5.4.1 (M). SIGN SHALL BE MOUNTED AT 60" ABOVE FINISHED FLOOR, TO CENTERLINE OF SIGN.

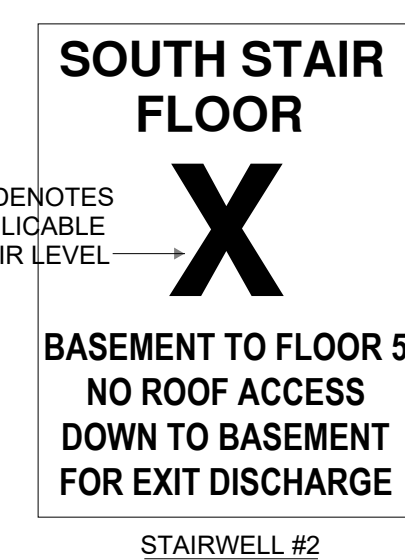

LIFE SAFETY PLAN LEVEL 1

SHEET NUMBER:

G-033