

STIPULATION FOR REUSE:  
 THIS DRAWING WAS PREPARED FOR USE ON A SPECIFIC SITE AT DULUTH, GA CONTEMPORANEOUSLY WITH ITS ISSUE DATE AS NOTED BELOW, AND IT IS NOT SUITABLE FOR USE ON A DIFFERENT PROJECT SITE OR AT A LATER TIME. USE OF THIS DRAWING FOR REFERENCE OR EXAMPLE ON ANOTHER PROJECT REQUIRES THE SERVICES OF PROPERLY LICENSED ARCHITECTS AND ENGINEERS. REPRODUCTION OF THIS DRAWING FOR REUSE ON ANOTHER PROJECT IS NOT AUTHORIZED AND MAY BE CONTRARY TO THE LAW.



CONSULTANTS:  
**Beach Engineering Solutions Team**  
 Mechanical, Electrical & Plumbing Engineering  
 (678) 665-3280  
 Project Number: 23-547

**THE STRICKLANDER**  
 MARRIOTT AUTOGRAPH  
 PUBLIC SPACE  
 6405 SUGARLOAF PARKWAY  
 DULUTH, GEORGIA 30097

INTERIM REVIEW  
 NOT FOR  
 REGULATORY  
 APPROVAL,  
 PERMITTING OR  
 CONSTRUCTION

ISSUE BLOCK:

DOCUMENT DATE: 04/02/2028  
 DRAWN BY: CL/YC  
 CHECKED BY: BGB  
 PROJECT NO.: JHD-024-NA-100002

SHEET TITLE:  
**PLUMBING  
 WATER FLOOR  
 PLAN -  
 BASEMENT**

SHEET NUMBER:  
**P-102**

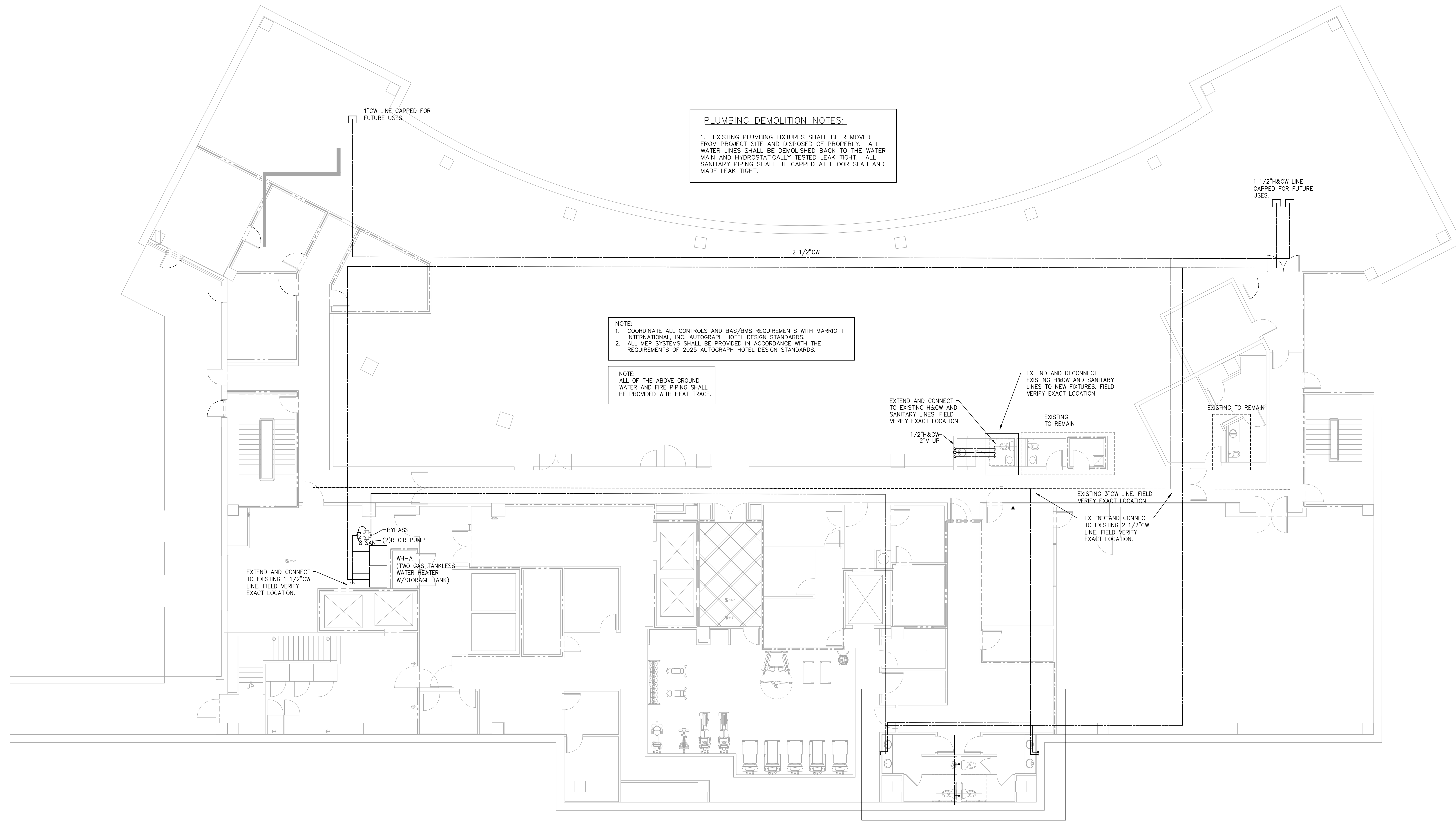

**PLUMBING DEMOLITION NOTES:**  
 1. EXISTING PLUMBING FIXTURES SHALL BE REMOVED FROM PROJECT SITE AND DISPOSED OF PROPERLY. ALL WATER LINES SHALL BE DEMOLISHED BACK TO THE WATER MAIN AND HYDROSTATICALLY TESTED LEAK TIGHT. ALL SANITARY PIPING SHALL BE CAPPED AT FLOOR SLAB AND MADE LEAK TIGHT.

NOTE:  
 1. COORDINATE ALL CONTROLS AND BAS/BMS REQUIREMENTS WITH MARRIOTT INTERNATIONAL, INC. AUTOGRAPH HOTEL DESIGN STANDARDS.  
 2. ALL MEP SYSTEMS SHALL BE PROVIDED IN ACCORDANCE WITH THE REQUIREMENTS OF 2025 AUTOGRAPH HOTEL DESIGN STANDARDS.

NOTE:  
 ALL OF THE ABOVE GROUND WATER AND FIRE PIPING SHALL BE PROVIDED WITH HEAT TRACE.

**1** Plumbing Water Floor Plan - Basement  
 SCALE: 1/8" = 1'-0"

SEE ENLARGED FLOOR PLAN